

Star mG-S Series Quick Setting Guide

Power on/off the scale

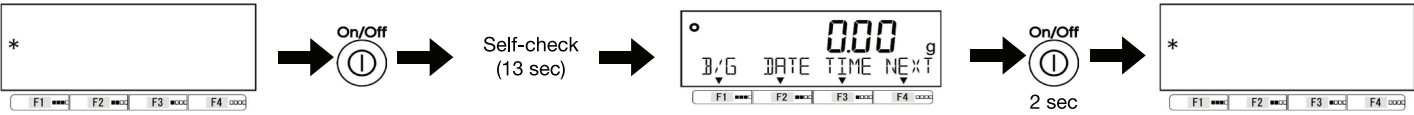

Operation Check

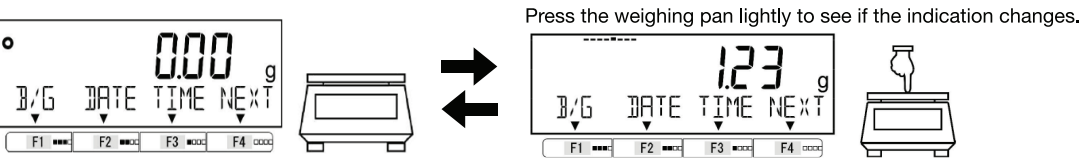

Zero-point Adjustment

This function makes the indicator zero without any loads.



Make sure nothing is on the pan
Note: When the weighing load exceeds $\pm 1.5\%$ of that capacity, this function cannot be executed.

Weighing a sample with a container (Tare)

This function makes the indicator zero without any loads.

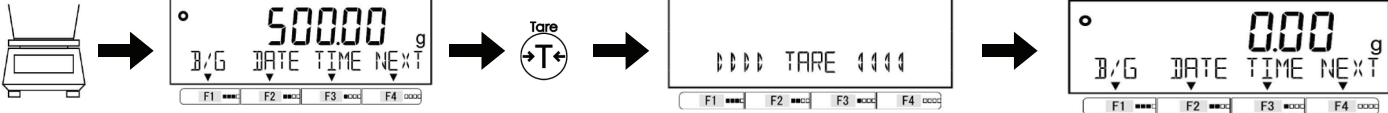

Note: When you want to clear the tare weight, please press “ZERO” button.

Change Unit

*The buttons under the display are F1, F2, F3, and F4 from left.

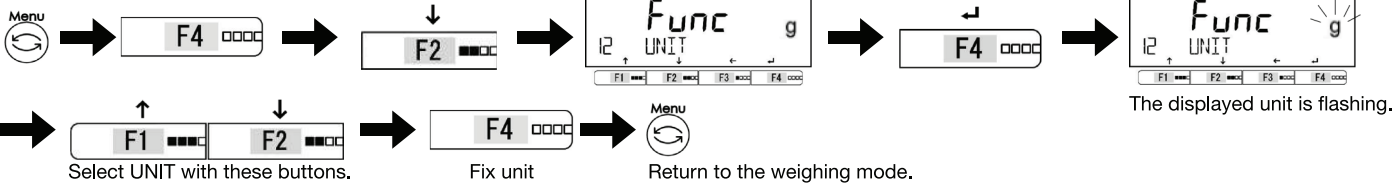

Connect to a tablet via Bluetooth Low Energy

Select the scale when your application is in the search function.

Scale names are as below.
(Default)
mG-S1501: mG-S1501XXXXXX

XX: The manufacture date
YYYY: The last 4 digits of the serial number
The serial number is on the label at the back.

For more details, please contact your software company.

Connect to Windows PC

- USB**
- Download the scale driver at the link below and install it on your PC.
(http://www.starmicronics.com/support/?printerCode=MG-S_Scale)
 - Connect the scale to PC with USB cable.
 - Turn on the scale.
 - The scale appears in “Devices and Printers” e.g. “STAR MG-1501 (COM4)”
 - In your POS application, choose the same COM port when configuring your scale.
- Use of USB bus power**
- Open “Properties” by right clicking on the scale name in “Ports (COM & LPT)” in “Device Manager”.
 - Check off “Allow the computer to turn off this device to save power” in “Power management” tab.
- Bluetooth**
- Turn on the scale.
 - Add Bluetooth device on you PC. The scale is in “Devices and Printers”. e.g. “MG-S1501XXXXXX”
 - Right click on the scale in the “Devices and Printers”, then, go to “Properties”.
 - You can see “COMn” in “Services” tab.(n means a port number).
 - In your POS application, choose the same COM port when configuration your scale.



Scale Support Guide

37967890

mG-S Series



mG-S1500 USCA
mG-S8200 US
mG-S8200 CA

Thank You for Purchasing Star’s mG-Scale!



Warning: To be legal for trade, the scale must be calibrated by a certified service company in your region. Each region's requirements are different. For more information and to find a certified service company, please refer to:

<https://starmicronics.com/Pages/mgscalesupport>

mG-S1501, mG-S8200



Check Supplied Accessories

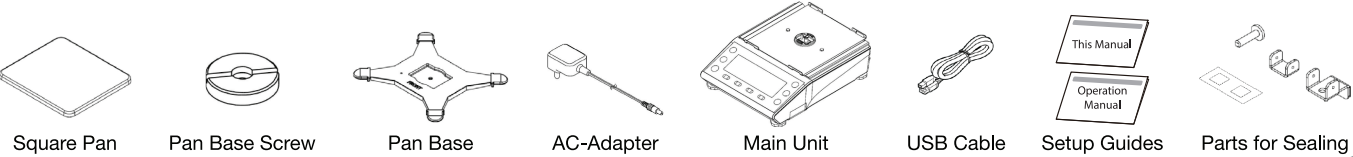

Assemble the Scale

- Put the pan base on the scale and fasten with pan base screw.

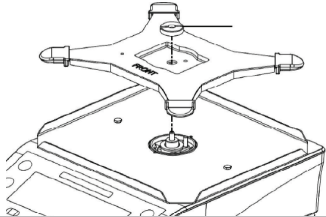

- Put the pan base on the scale.

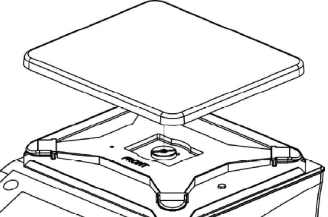

- Put the pan base on the scale.

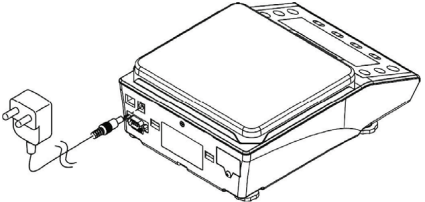

Level the Scale

- Before turning on the scale, place the scale on a stable surface. Then, adjust the four feet at the corners.

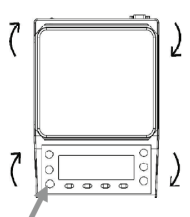

- Make sure the level bubble is in the center as below.

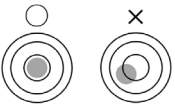



WARNING: SCALE MUST BE CALIBRATED BY A REGISTERED TECHNICIAN OF YOUR REGION.

Star mG-S Series Calibration Guide

What you need

- Calibration weight (OIML F1 Class)
- Security sealing items included in the box
- Non-conductive thin rod
- Operation manual (<http://www.star-m.jp/prjump/000106.html>)

1 Leveling the scale

Adjust footers at the bottom corners of the scale. Refer to the operation manual.

2 Calibration

Please turn on the scale more than 30 minutes before the calibration and load the calibration weights few times. Follow the instruction of “Span calibration with external weight” in the operation manual. We recommend using the capacity weight.

mG-S1501: 1500 g

mG-S8200: 8200 g

If you don't use a weight more than one-half of the capacity, the “UC” is displayed when weighing more than twice heavy calibration weight because the weighing accuracy is not guaranteed.

3 Lock the security switch

1. Turn off the scale and unplug the power cable. If the windshield is attached, remove it.
2. Remove the sticker at the front bottom of the scale as shown below.



3. Set the security switch to Locked position. This switch is at “Unlocked position” as default.

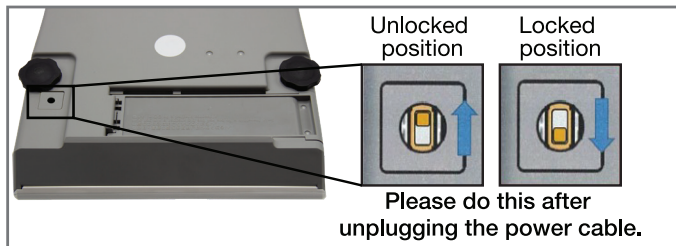

4 Sealing

Security stickers or a plate should be attached as below. If the state requires a wire sealing, use a lock plate on the back of the scale as below. Please refer to “Star MG-S Series Wire sealing Guide”.

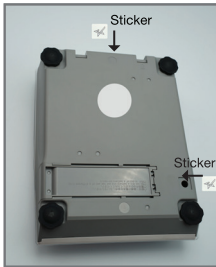

5 Verification

A weights and measures official or authorized service agent must perform the verification procedure.

6 Star mG-S Series Wire Sealing Guide mG-S1501, mG-S8200

- 1 Take off a screw on the back.

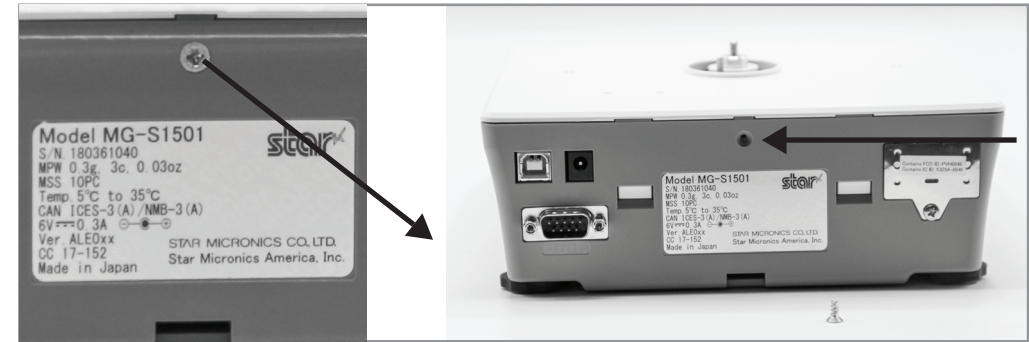

- 2 Attach wire sealing holder to back of scale using the back screws.



- 3 Run wire through the 2 holes and secure them to the counter.

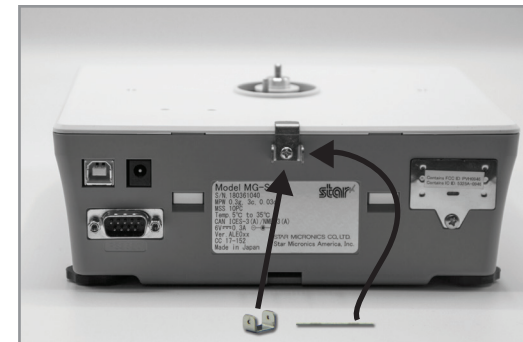

- 4 See below view of secured lock with wire.

